

HOEFER AZZERO CARAVAN - ALL TERRAIN



Body Construction - Aircraft-derived, wood-free, composite monocoque

Chassis Construction - Structural Aircraft - Aluminium bonded and SS fastened

FEATURES	DETAILS
Sleeps	4
Overall Length	7.5 m
Overall Width	2.34 m
Overall Height	2.75 m
Nose wheel	Oversized
4x4 stabilizers	Y
Weight GVM (kg)	1510 kg
Licensing Mass (Tara)	1250 kg
Loading Capacity (kg)	260 kg
Axles	1 (2-ton axle)
Tyres	205/75 R 15 4x4
Rims	15" 4x4 Mags
AKS Anti-Sway Coupler	2.7-ton
Brakes	230mm
220V Power Pack, Battery	Y
Patio Roof/Tent Roof	Tent
Tent Sides	Y
Ground Sheet	N
Full outside kitchen	Y
Euro pull-out sink/stove	Y
Fridge to outside	100L 220v
Microwave Oven	Y
Hot Water Geyser (Elec)	Y - 220v
Gas Cylinder	N

FEATURES	DETAILS
Bathroom/Water Closet	BR
Shower	Y
Water Tank (WT) or Bottle (B)	WT - 120L
Self-filling Water System	Y - 12v water pump
Lounge / Bed Configuration	Y - Sleeps 2 Adults
Portable Toilet (PT)/Cassette	Cassette
Fridge in living room	200L 220v
Island Bed	Y
Aircon in bedroom	Standard
Roof Vent	3
Interior Lights	12V LED
Exterior Light	12V LED
Outside Multi Plug	2
USB Charger	Y

OPTIONAL ACCESSORIES

Full Tent	DEMO SPECIAL
Multi Room Tent	POA
Added Room Tent	POA
Bike Mounting Frame	POA
Travel Blanket	POA
Caravan Cover	POA
Caravan Movers	POA
Air Conditioning	DEMO SPECIAL

**Demo Special Price
Including Full Tent**

R 511 867.00 Incl. Vat

Michael email: michael@gcgypsey.co.za
Gert email: sales@gcgypsey.co.za
Alinda email: admin@gcgypsey.co.za

www.hoefergroup.com
www.gccaravans.co.za

Phone no: 013 697 5121 / 2
Errors and Omissions Exepted (E & OE)

Azzero | 1250kg Tare

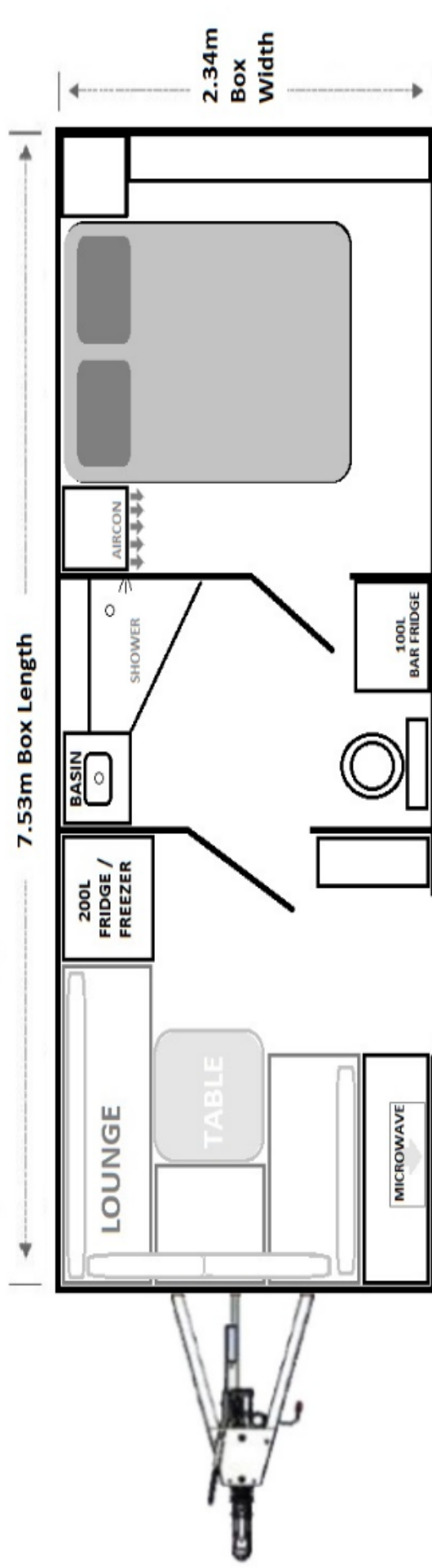

construction

- World's lightest gravel road caravan design
- 100% aircraft monocoque body & chassis
- 100% wood-free, rot-proof
- Maintenance-free exterior seals
- Improved resistance to hail / debris
- Subultralight design = fuel efficient towing
- Extreme aerodynamics = fuel efficient towing
- Meticulous weight balancing = safer towing
- High impact, shock-resistant resins / adhesives
- Superyacht / supercar body structure materials
- Superyacht gel coat = improved colour stability
- 100% structurally insulated body incl. roof, caps

exterior features

- Euro windows w/ reflective shades and fly screen
- Luxury outside kitchen w/ Euro sink+stove
- Euro roof hatch with shade and fly screen
- Marine-style Euro entry door w/ window+shade
- Marine entry door grab handle
- Premium mill-finish aluminium front gravel guard
- Aircraft aluminium satin black anodized chassis
- Galvanized axle, jockey wheel, coupler, jacks
- 1800kg AIKO rubber torsion axle w/ 9" brakes
- 205/75R15C Conti 4x4 tyres w/ A-line 4x4 rims
- Matching spare tyre and rim standard

interior / utilities

- Yacht-quality interior w/ 10-year flooring
- 3-layer memory foam lounge seats
- Laser-cut seat back cushions w/ natural recline
- Custom yacht-grade leather lounge upholstery
- Island bed w/ 3-layer memory foam mattress
- Hand-crafted solid surface counter tops / table
- Hand-crafted solid surface cabinetry
- Chrome push button cabinet latches
- Chrome and stainless cabinet hinge finishings
- 120L fresh water tank
- Hansen 220v geyser